

The Warrenton



The Warrenton's traditional design features an expansive family room, kitchen and nook combination. The foyer is flanked by the formal living and formal dining rooms. On the second floor, the master suite features a huge walk-in closet. Two additional bedrooms, a study and a bath round out the upper level.

The Warrenton

3 Bedrooms, 2.5 Baths

1,106 1st Floor, 1,106 2nd Floor, 2,213 Living Area

27'8" x 40' Dimensions

The Warrenton

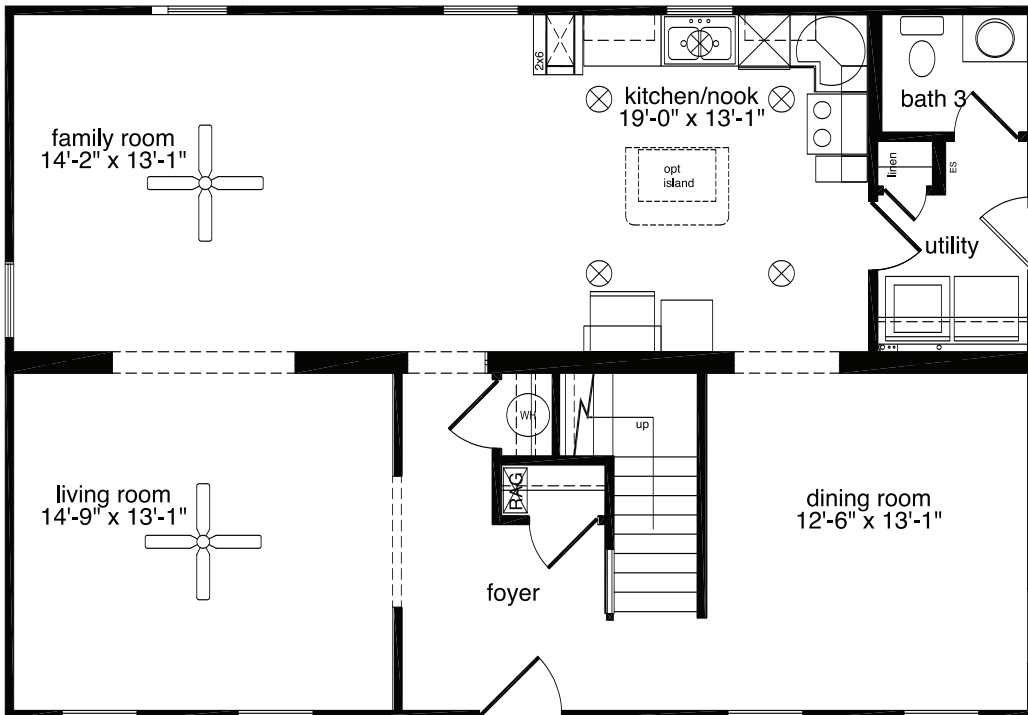
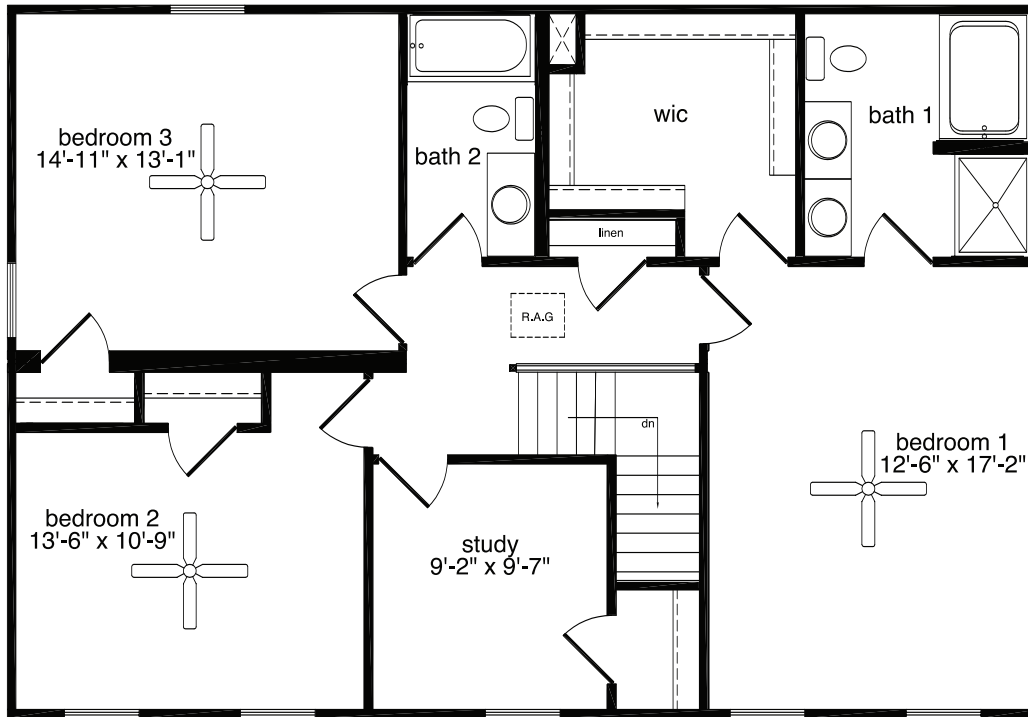

All home elevations are artist renderings and may vary from actual construction. All floor plans and room sizes are approximate. All information contained is the sole property of HandCrafted Homes



HandCrafted Homes
A BETTER WAY TO BUILD

The Warrenton

3 Bedrooms, 2.5 Baths
1,106 1st Floor, 1,106 2nd Floor, 2,213 Living Area
27'8" x 40' Dimensions

877.424.4321



436.0001

430.6662 fax

101 Eastern Minerals Rd

Henderson, NC

27537

www.HandCraftedHomes.com